

Features

Designed to form heavy duty mobile scaffolding and other transport units. Total lock design, steel-welded, lock swivel head and wheel. Patented cast steel swivel head with ratchet design, brake more firmly. Plate fitting. Threaded king pin and locking nut secured, grease nipple, wheel axle with nut.

Finish (Inquires on other finishes welcome).

Z: Zinc

Wheel Bearing

R: Roller bearing (Standard).



SGS TEST REPORT available.

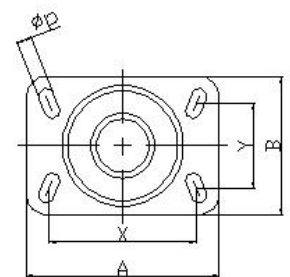
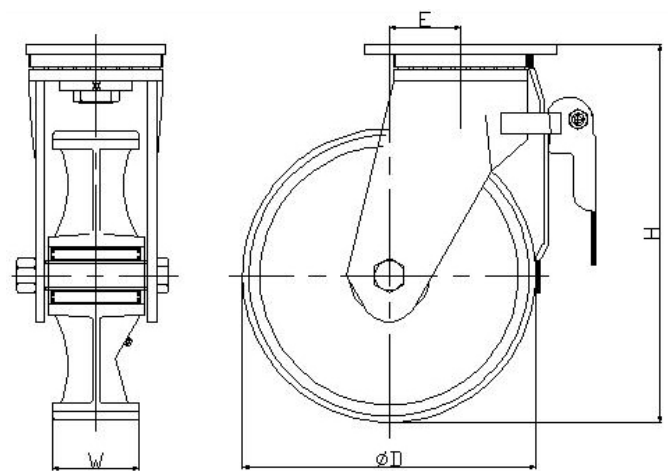

Top Plate



▼ Red Polyurethane tread ▼ Cast Iron hub

SPEC (inch)	Capacity Each (lbs)	Wheel Dia. D(mm)	Wheel Width W(mm)	Wheel Bearing Type	Swivel Radius E(mm)	Overall Height H(mm)
10"	1800	250	75	Roller	63	337
12"	2200	300	75	Roller	73	376

A×B(mm)	X×Y(mm)	P(mm)
166×120	129×74	13.0
166×120	129×74	13.0